

REVISION		
REV.	DESCRIPTION	DATE
A		JUNE.22.2005.

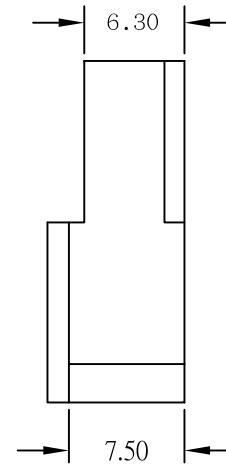
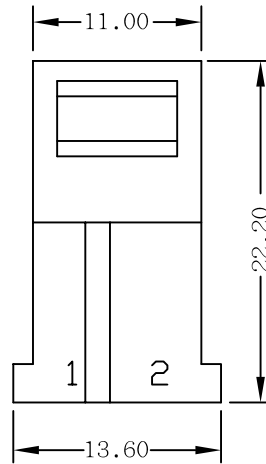
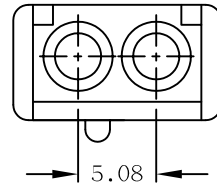

### SPECIFICATIONS

Current rating : 5.0A AC,DC

Voltage rating : 250V AC,DC

Temperature range : -25°C to +85 °C

Contact resistance : 10m Ω Max.

Insulation resistance : 1000M Ω Min.

Withstanding voltage : 800V AC/minute

Material : Nylon 66, UL94V-2

GENERAL DIMENSION TOLERANCE	X.X ±0.25	X.XX ±0.15	X.XXX ±0.08
--------------------------------	--------------	---------------	----------------

<b>DRAWN BY:</b>	Storm.Li	<b>CUSTOMER</b>		<b>THIRD ANGLE PROJECTION</b>		<b>UNITS:</b>	<b>mm</b>
<b>CHECKED BY:</b>	Simmon Zhang	<b>Title:</b>	Housing	<b><i>SOUTH SEA TERMINAL CO.,LTD</i></b>			
<b>APPROVED BY:</b>	Tony Chou	<b>P/NO:</b>	SPS2-M02				