

DRAWING OF FINISHED PRODUCTS

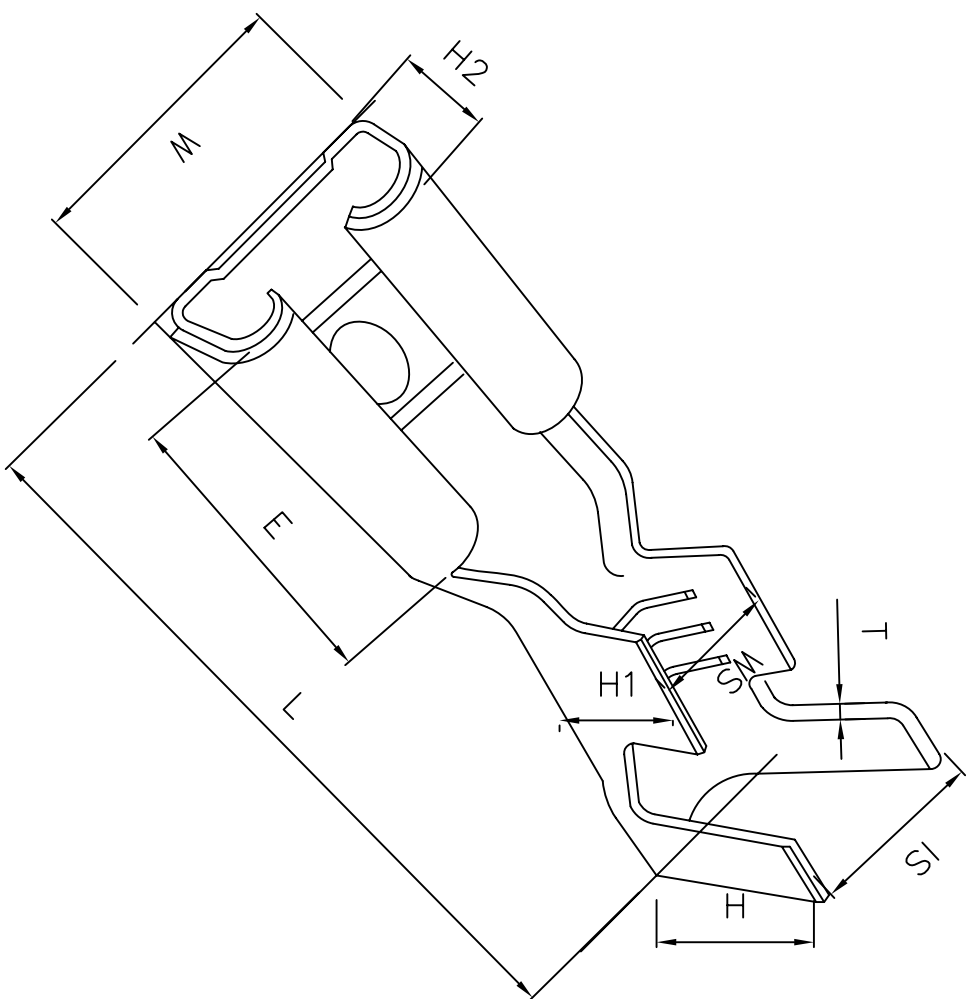

ITEM NO: S1764T-2
 MATERIAL: BRASS
 THICKNESS: 0.4
 HARDNESS: SH
 PLATING: TIN 40μ' MIN
 WIRE RANGE: (AWG) 14-20
 INSULATION O.D.: 3.8 MAX.
 VOL TAGE RATING: AC/250V, DC/350V
 CURRENT RATING: AC, DC, 15A
 TEMPERATURE RANGE: -25°C TO +85°C
 MATE: 0.8 THICKNESS PIN

DIMENSION: (MM)
 T: 0.4 ± 0.03
 L: 19.0 ± 0.35
 E: 7.7 ± 0.25
 W: 7.6 ± 0.2
 IS: 5.1 ± 0.35
 WS: 3.4 ± 0.3
 H: 5.0 ± 0.25
 H1: 3.4 ± 0.25
 H2: 3.08 ± 0.1

Rev	Description/Date	Drawn By: Storm.li	Customer:	Title:	
△	Sample/Aug.31.2006	Checked By: Simmon	Part No.:	250 Tab-on Terminal	
△		Approved By: Tony	General Dimension Tolerance	SOUTH SEA TERMINAL CO., LTD	
SGS Report No.:			Third angle projection	Units:	X ± .X ± 0.40 .XX ± 0.30 .XXX ±