

DRAWING OF FINISHED PRODUCTS

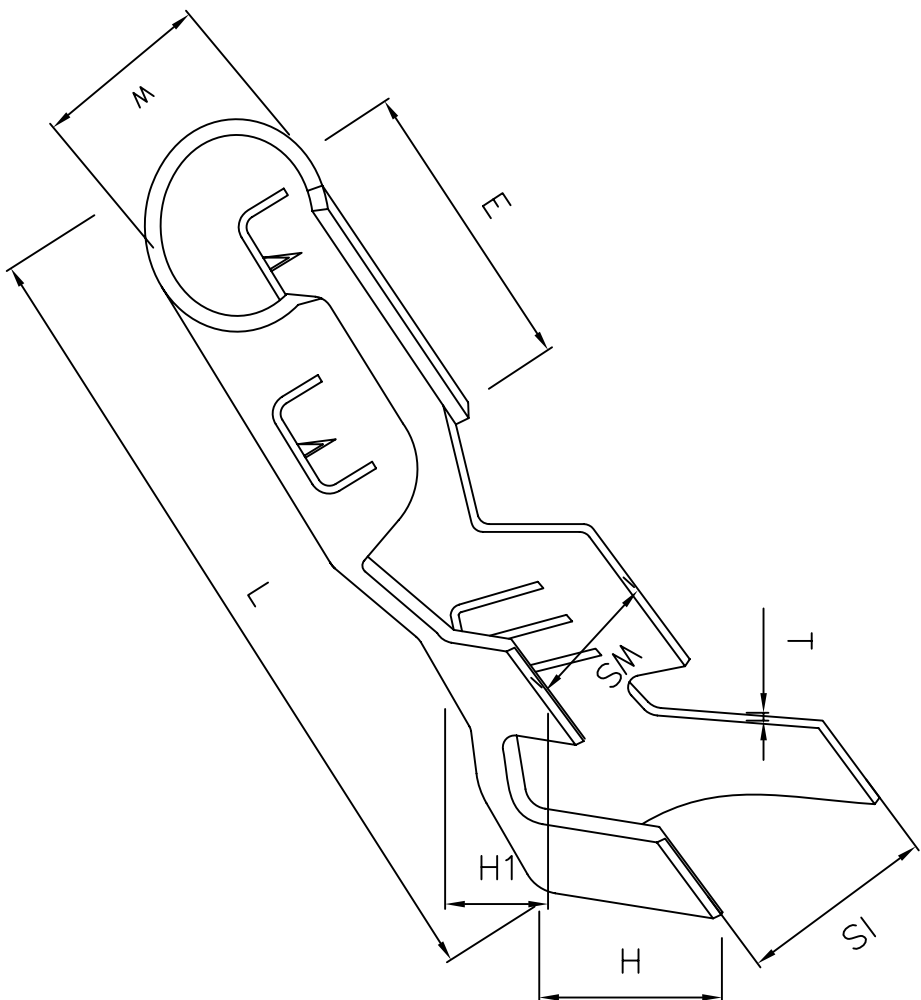

ITEM NO: S1141T-2
 MATERIAL: BRASS
 THICKNESS: 0.4
 HARDNESS: SH
 PLATING: TIN 40µ' MIN
 WIRE RANGE: (AWG) 14-20
 INSULATION D.D.: 3.8 MAX.
 VOLTAGE RATING: AC/250V, DC/350V
 CURRENT RATING: AC, DC, 15A
 TEMPERATURE RANGE: -25°C TD +85°C
 MATE: Ø3.5 ROUND PIN

DIMENSION: (MM)
 T: 0.4±0.03
 L: 17.4±0.35
 E: 6.5±0.25
 W: 4.2±0.2
 IS: 5.0±0.35
 WS: 3.3±0.35
 H: 5.0±0.25
 H1: 3.3±0.25

Rev	Description/Date	Drawn By: Storm.li	Customer:	
△	Sample/Aug.31.2006	Checked By: Simmon	Part No.:	S1141T-2
△		Approved By: Tony	Title:	4.00 Dia Bullet Female
SGS Report No.:			SOUTH SEA TERMINAL CO., LTD	
	Third angle projection		Units:	X± .X±0.40 .XX±0.30 .XXX±
	General Dimension Tolerance			