

A-A

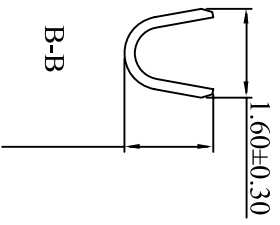

B-B

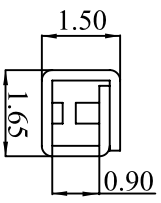

C-C

Terminal

- Part No. : 254G3-GP
- Applicable Wires : AWG# 22 - 28
- Material : Brass
- Finish : Gold plated/ gold flash,
Tin plated
- Thickness : 0.20mm
- Q'ty : 10000pcs./Reel
- Use in 254G3-1HXX,254G3-2HXX Housing

Rev	Description/Date	Drawn By: Storm.li	Customer:	Third angle projection	Units: mm						
△		Checked By: Simmon	Part No.: 254G3-GT		<table border="0"> <tr> <td>X.X</td> <td>X.XX</td> <td>X.XXX</td> </tr> <tr> <td>±0.50</td> <td>±0.10</td> <td>±0.08</td> </tr> </table>	X.X	X.XX	X.XXX	±0.50	±0.10	±0.08
X.X	X.XX	X.XXX									
±0.50	±0.10	±0.08									
△		Approved By: Tony	Title: 2.54 mm Wire to Board Terminal								
SGS Report No.:											

SOUTH SEA TERMINAL CO.,LTD