

# SST APPROVAL SHEET

Customer: \_\_\_\_\_

Customer P/N.: \_\_\_\_\_

SST P/N.: 013116R \_\_\_\_\_

Description: GRIPER \_\_\_\_\_

Approved No.: \_\_\_\_\_

Date: \_\_\_\_\_

## Manufacturer's specification

Designed By:	Checked By:	Acknowledged By:
Simmon Chang	May Yang	Tony Chou

## Customer Signature

Inspected By:	Checked By:	Approved By:

## SOUTH SEA TERMINAL CO.,LTD.

Headquarter: 6f,No.179,Sec.1,ShinTai Wu Rd.Hsi Tzih City,Taipei County,Taiwan R.O.C.

Tel:+886-2-2641-1098 Fax:+886-2-2642-8853 E-mail:sstasia@sstasia.com.tw

Web site [http// www.sstasia.com.tw](http://www.sstasia.com.tw)

Cable-Shen Zhen : B1-B2 Shang Tang Industry District,Zhong-Huan Nan Rd,LongHua Town,Bao'An County,Shen Zhen City,Guangdong Province,China(518131)

Tooling-China : No.4 Industry District,Xin Ye Rd.,Xiagang Village Changan Town, Dongguan,Guangdong Province,China

1. Material: Braas(C2680-EH)
2. Plated-Tin-Plated
3. Hole dia: 1.9mm dia.
4. Insertion force: 1.5-2.0Kgs min.
5. Q'ty: 10,000 Pcs/reel

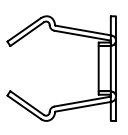
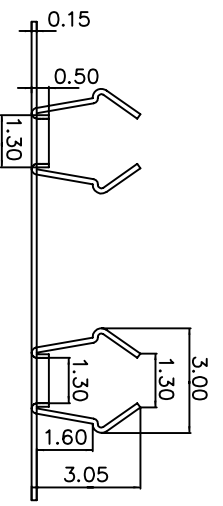
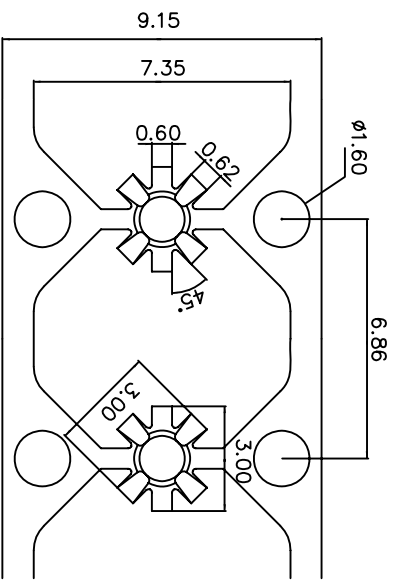

Insertion force : 1.5-2.0KG

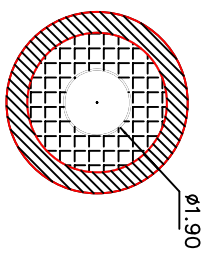
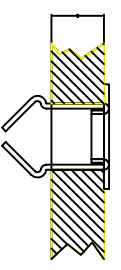

Rev	Description/Date	Drawn By: Storm.li	Customer:	BEKO	Third angle projection	Units: mm
△		Checked By: Simmon	Part No.:	013116R	General Dimension Tolerance	X.X ±0.25 X.XX ±0.1 X.XXX ±0.08
△		Approved By: Tony	Title:	Terminal		
SGS Report No.: CE/2004/71323						

**SOUTH SEA TERMINAL CO., LTD**